

SILICA

TILE.WARE



CATALOG 2026

SILICACO.COM



SBP310 STAINLESS STEEL 304/316

SBP310 is a square edging profile by bending of V-shaped groove, made of stainless steel grade 304 or 316, with either shiny, brushed or BA finish surface.

The colors of regular PVD process can be: silver, gold, champagne gold, rose gold, black, etc. It's widely applied to corners and edging of tiles, stones, wooden laminates, floorboards.

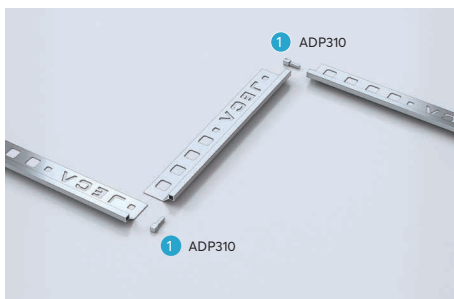
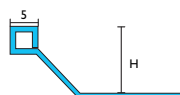

Inside corner & Outside corner are the same

Item No.	Height (mm)	Length (mm)	SS Thickness (mm)	Color
SBP310-10H	10	2440	0.8 / 1.0	1S,2S,3S,4S
SBP310-12H	12	2440	0.8 / 1.0	1B,2B,3B,4B

* The color and size can be customized.
Color option refer to (Page 6).

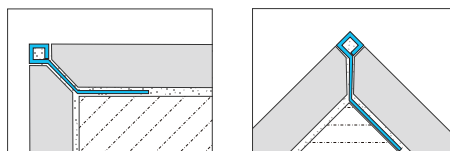

INSTRUCTIONS:

1. Cut profile to the desired length and apply the adhesive on the support where the profile will be laid.
2. Clean the residue or grease on the substrate, tile or stone.
3. Apply the adhesive to the surface of the substrate.
4. Press the anchoring flange of profile into the adhesive.
5. Apply adhesive to the back of the tile, lay the tiles on floor and wall aligning them with the profile leaving a 2mm joint.
6. Fill the joints between the profile and the tiles with grout, in order to avoid water stagnation.
Remove immediately all the remains of grout from the surface of the profile and tile.

TILE EDGING PROFILES



SBP110 STAINLESS STEEL 304/316

SBP110 is a square edging profile by bending of V-shaped groove, made of stainless steel grade 304 or 316, with either shiny, brushed or BA finish surface.

The colors of regular PVD process can be: silver, gold, champagne gold, rose gold, black, etc.

Perfect edge protection covers in heights from 8-15mm.

It's widely applied to corners and edging of tiles, stones, wooden laminates, floorboards.

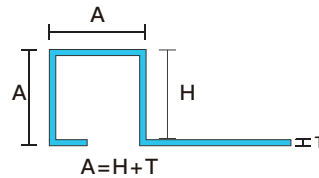

Item No.	Height (mm)	Length (mm)	SS Thickness (mm)	Color
SBP110-8H	8	2440	0.6 / 0.8 / 1.0	1S,2S,3S,4S
SBP110-10H	10	2440	0.6 / 0.8 / 1.0	1B,2B,3B,4B
SBP110-12H	12	2440	0.6 / 0.8 / 1.0	1F,1BA

* The color and size can be customized. Color option refer to (Page 6).

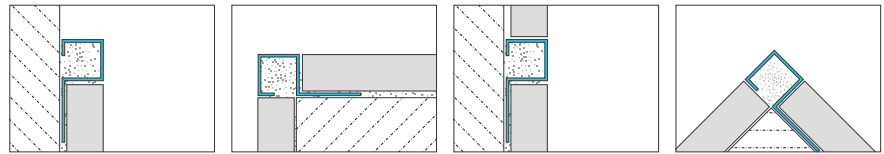

INSTRUCTIONS:

1. Cut profile to the desired length and apply the adhesive on the support where the profile will be laid.
2. Clean the residue or grease on the substrate, tile or stone.
3. Apply the adhesive to the surface of the substrate.
4. Press the anchoring flange of profile into the adhesive.
5. Apply adhesive to the back of the tile, lay the tiles on floor and wall aligning them with the profile leaving a 2mm joint.
6. Fill the joints between the profile and the tiles with grout, in order to avoid water stagnation. Remove immediately all the remains of grout from the surface of the profile and tile.



Item No.	Height (mm)	Color	Remark
ADP110-8H	8	1S,2S,3S,4S	Inside corner & Outside corner are the same
ADP110-10H	10	1B,2B,3B,4B	
ADP110-12H	12	1F,1BA	

TILE EDGING PROFILES

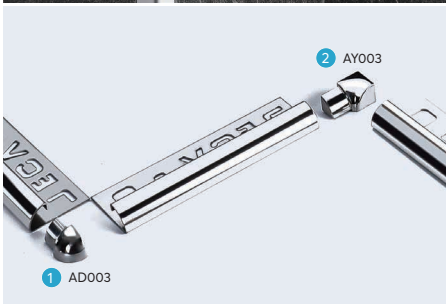
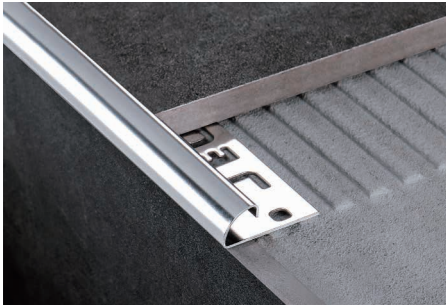

SR003 STAINLESS STEEL 304/316

SR003 is a round edging profile, made of stainless steel grade 304 or 316, with either shiny, brushed or BA finish surface. The colors of regular PVD process can be: silver, gold, champagne gold, rose gold, black, etc.

Perfect edge protection covers in heights from 6-15mm.

It's widely applied to corners and edging of tiles, stones, wooden laminates, floorboards.

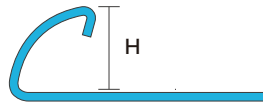

Item No.	Height (mm)	Length (mm)	SS Thickness (mm)	Color
SR003-6H	6	2440	0.6 / 0.8 / 1.0	1S,2S,3S,4S 1B,2B,3B,4B 1F,1BA
SR003-8H	8	2440	0.6 / 0.8 / 1.0	
SR003-10H	10	2440	0.6 / 0.8 / 1.0	
SR003-11H	11	2440	0.6 / 0.8 / 1.0	
SR003-12H	12	2440	0.6 / 0.8 / 1.0	
SR003-12.5H	12.5	2440	0.6 / 0.8 / 1.0	

* The color and size can be customized.
Color option refer to (Page 6).

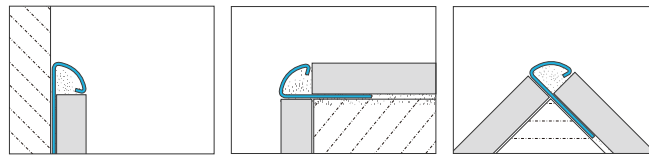

INSTRUCTIONS:

1. Cut profile to the desired length and apply the adhesive on the support where the profile will be laid.
2. Clean the residue or grease on the substrate, tile or stone.
3. Apply the adhesive to the surface of the substrate.
4. Press the anchoring flange of profile into the adhesive.
5. Apply adhesive to the back of the tile, lay the tiles on floor and wall aligning them with the profile leaving a 2mm joint.
6. Fill the joints between the profile and the tiles with grout, in order to avoid water stagnation.
Remove immediately all the remains of grout from the surface of the profile and tile.

Item No.	Height (mm)	Color	Remark
AD003-6H	6	1S,2S,3S,4S 1B,2B,3B,4B 1F,1BA	Outside corner
AD003-8H	8		
AD003-10H	10		
AD003-11H	11		
AD003-12H	12		
AD003-12.5H	12.5		

Item No.	Height (mm)	Color	Remark
AY003-6H	6	1S,2S,3S,4S 1B,2B,3B,4B 1F,1BA	Inside corner
AY003-8H	8		
AY003-10H	10		
AY003-11H	11		
AY003-12H	12		
AY003-12.5H	12.5		

TILE EDGING PROFILES



SBP019 STAINLESS STEEL 304/316

SBP019 is a L shape edging profile by bending of V-shaped groove, made of stainless steel grade 304 or 316, with either shiny, brushed or BA finish surface.

The colors of regular PVD process can be: silver, gold, champagne gold, rose gold, black, etc.

Perfect edge protection covers in heights from 10-15mm.

It's widely applied to corners and edging of tiles, stones, wooden laminates, floorboards.

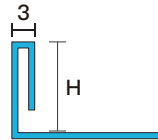

Item No.	Height (mm)	Length (mm)	SS Thickness (mm)	Color
SBP019-10H	10	2440	0.6 / 0.8	1S,2S,3S,4S
SBP019-12H	12	2440	0.6 / 0.8	1B,2B,3B,4B,1F,1BA

* The color and size can be customized.
Color option refer to (Page 6).

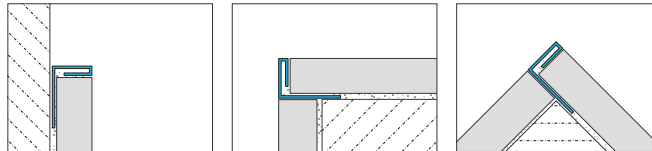

INSTRUCTIONS:

1. Cut profile to the desired length and apply the adhesive on the support where the profile will be laid.
2. Clean the residue or grease on the substrate, tile or stone.
3. Apply the adhesive to the surface of the substrate.
4. Press the anchoring flange of profile into the adhesive.
5. Apply adhesive to the back of the tile, lay the tiles on floor and wall aligning them with the profile leaving a 2mm joint.
6. Fill the joints between the profile and the tiles with grout, in order to avoid water stagnation.
Remove immediately all the remains of grout from the surface of the profile and tile.

DECORATIVE TILE PROFILES

SUP series is a U shape decorative profile by bending of V-shaped groove, made of stainless steel grade 304 or 316, with either shiny, brushed or BA finish surface. The colors of regular PVD process can be: silver, gold, champagne gold, rose gold, black, etc. It's widely applied to flooring transition, wall decorative strips of tiles, stones, wooden laminates, floorboards.

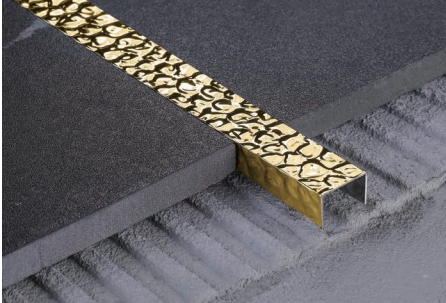

SUP10 STAINLESS STEEL 304/316

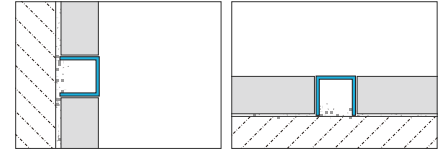
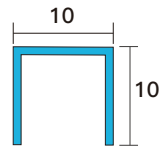

Item No.	Height (mm)	Length (mm)	SS Thickness (mm)	Color
SUP10	10	2440	0.6 / 0.8 / 1.0	1S,2S,3S,4S

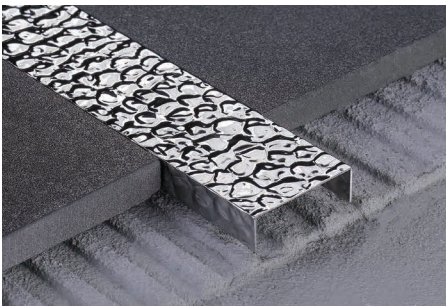

SUP30 STAINLESS STEEL 304/316

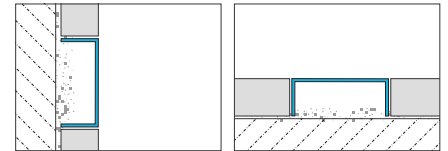
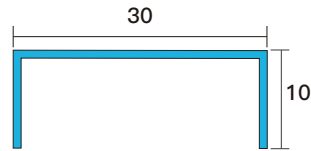

Item No.	Height (mm)	Length (mm)	SS Thickness (mm)	Color
SUP30	10	2440	0.6 / 0.8 / 1.0	1S,2S,3S,4S

DECORATIVE TILE PROFILES

SUP series is a U shape decorative profile by bending of V-shaped groove, made of stainless steel grade 304 or 316, with either shiny, brushed or BA finish surface. The colors of regular PVD process can be: silver, gold, champagne gold, rose gold, black, etc.

It's widely applied to flooring transition, wall decorative strips of tiles, stones, wooden laminates, floorboards.



SUP03 STAINLESS STEEL 304/316

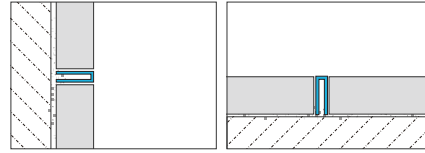
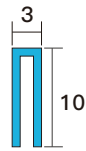

Item No.	Height (mm)	Length (mm)	SS Thickness (mm)	Color
SUP03	10	2440/3050	0.6 / 0.8	1S,2S,3S,4S,1B,2B,3B,4B,1F

* The color and size can be customized. Color option refer to (Page 6).



SUP05 STAINLESS STEEL 304/316

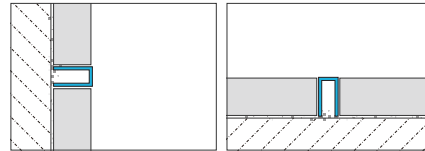
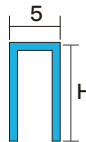

Item No.	Height (mm)	Length (mm)	SS Thickness (mm)	Color
SUP05	5 / 10	2440 / 3050	0.6 / 0.8 / 1.0	1S,2S,3S,4S,1B,2B,3B,4B,1F

* The color and size can be customized. Color option refer to (Page 6).



SUP08 STAINLESS STEEL 304/316

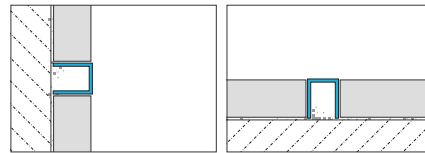
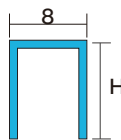

Item No.	Height (mm)	Length (mm)	SS Thickness (mm)	Color
SUP08	8 / 10	2440 / 3050	0.6 / 0.8 / 1.0	1S,2S,3S,4S,1B,2B,3B,4B,1F

* The color and size can be customized. Color option refer to (Page 6).

DECORATIVE TILE PROFILES

STP145 is a T shape decorative profile by bending of V-shaped groove, made of stainless steel grade 304 or 316, with either shiny, brushed or matt surface. The colors of regular PVD process can be: silver, gold, champagne gold, rose gold, black, etc.

Profile covers in width from 6-20mm.

It's widely applied to flooring transition, wall decorative strips of tiles, stones, wooden laminates, floorboards.



STP145-6W STAINLESS STEEL 304/316

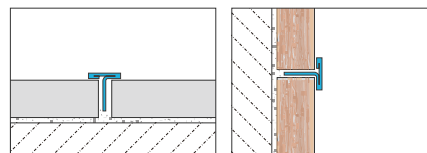
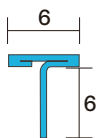

Item No.	Height (mm)	Length (mm)	SS Thickness (mm)	Color
STP145-6W	6	2440/3050	0.5 / 0.6	1S,2S,3S,4S,1B,2B,3B,4B,1F

* The color and size can be customized. Color option refer to (Page 6).



STP145-10W STAINLESS STEEL 304/316

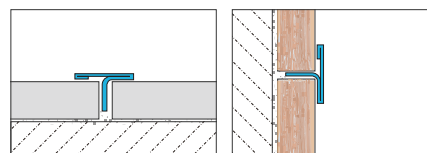
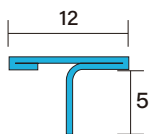

Item No.	Height (mm)	Length (mm)	SS Thickness (mm)	Color
STP145-10W	5	2440/3050	0.5 / 0.6 / 0.8	1S,2S,3S,4S,1B,2B,3B,4B,1F

* The color and size can be customized. Color option refer to (Page 6).

TILE PROFILES FOR TRANSITIONS



SBP019 STAINLESS STEEL 304/316

SBP019 is a L shape transition profile by bending of V-shaped groove, made of stainless steel grade 304 or 316, with either shiny, brushed or BA finish surface. The colors of regular PVD process can be: silver, gold, champagne gold, rose gold, black, etc. Profile covers in heights from 10-15mm.

It's widely applied to transition of tile, stone, wooden laminates, floorboards and wall decorative strips.

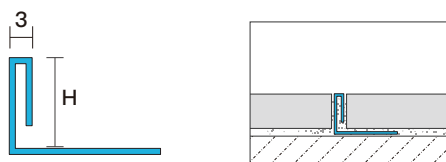

Item No.	Height (mm)	Length (mm)	SS Thickness (mm)	Color
SBP019-10H	10	2440	0.6 / 0.8	1S,2S,3S,4S
SBP019-12H	12	2440	0.6 / 0.8	1B,2B,3B,4B,1F,1BA

* The color and size can be customized.
Color option refer to (Page 6).

INSTRUCTIONS:

1. Cut profile to the desired length and apply the adhesive on the support where the profile will be laid.
2. Clean the residue or grease on the substrate, tile or stone.
3. Apply the adhesive to the surface of the substrate.
4. Press the anchoring flange of profile into the adhesive.
5. Apply adhesive to the back of the tile, lay the tiles on floor and wall aligning them with the profile leaving a 2mm joint.
6. Fill the joints between the profile and the tiles with grout, in order to avoid water stagnation.
Remove immediately all the remains of grout from the surface of the profile and tile.

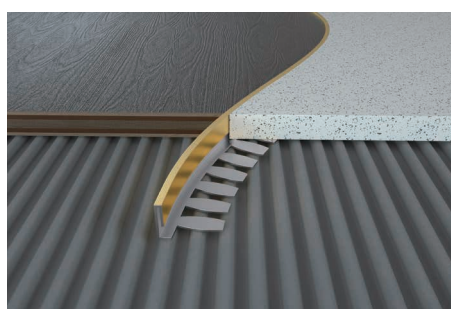

SBP019 Z-Flex STAINLESS STEEL 304/316

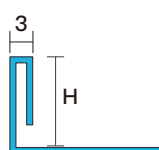

Item No.	Height (mm)	Length (mm)	SS Thickness (mm)	Color
SBP019-10H	10	2440	0.6 / 0.8	1S,2S,3S,4S
SBP019-12H	12	2440	0.6 / 0.8	1B,2B,3B,4B,1F,1BA

* The color and size can be customized.
Color option refer to (Page 6).

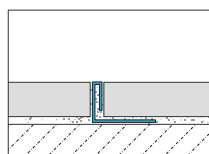

INSTRUCTIONS:

1. Cut profile to the desired length and apply the adhesive on the support where the profile will be laid.
2. Clean the residue or grease on the substrate, tile or stone.
3. Apply the adhesive to the surface of the substrate.
4. Press the anchoring flange of profile into the adhesive.
5. Apply adhesive to the back of the tile, lay the tiles on floor and wall aligning them with the profile leaving a 2mm joint.
6. Fill the joints between the profile and the tiles with grout, in order to avoid water stagnation.
Remove immediately all the remains of grout from the surface of the profile and tile.

STAIR NOSING PROFILES FOR TILES

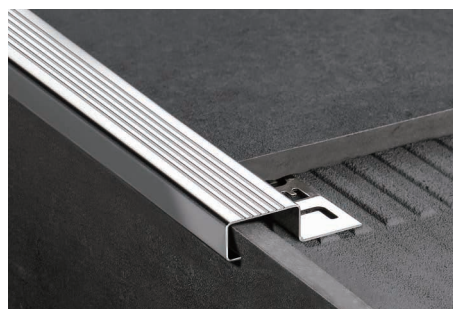

SB022

SB022 is a stair nosing and anti-slip profile by bending, made of stainless steel grade 304 or 316, with either shiny, brushed or BA finish surface. The colors of regular PVD process can be: silver, gold, champagne gold, rose gold, black, etc.

Profile covers in heights from 10-15mm.

It's mainly applied to stair nosing and anti-slip of stairs, floor, tiles, stones.

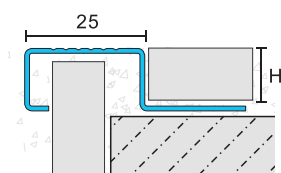

Item No.	Height (mm)	Length (mm)	SS Thickness (mm)	Color
SB022-10H	10	2440	0.8 / 1.0	1S,2S,3S,4S
SB022-12H	12	2440	0.8 / 1.0	1B,2B,3B,4B
SB022-14H	14	2440	0.8 / 1.0	1F,1BA

★ The color and size can be customized.
Color option refer to (Page 6).

INSTRUCTIONS:

1. Cut profile to the desired length and apply the adhesive on the support where the profile will be laid.
2. Clean the residue or grease on the substrate, tile or stone.
3. Apply the adhesive to the surface of the substrate.
4. Press the anchoring flange of profile into the adhesive.
5. Apply adhesive to the back of the tile, lay the tiles on floor and wall aligning them with the profile leaving a 2mm joint.
6. Fill the joints between the profile and the tiles with grout, in order to avoid water stagnation.
Remove immediately all the remains of grout from the surface of the profile and tile.

STAIR NOSING PROFILES FOR TILES



SBQ259 STAINLESS STEEL 304/316

SBQ259 is a circle-arc stair edging profile by bending, made of stainless steel grade 304 or 316, with either shiny, brushed or BA finish surface. The colors of regular PVD process can be: silver, gold, champagne gold, rose gold, black, etc.

Profile covers in heights from 8-15mm.

It's mainly applied to stair edging of stairs, floor, tiles, stones.

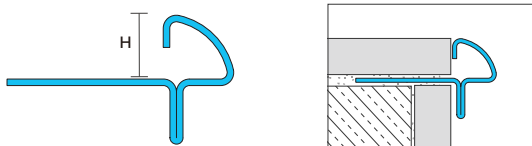

Item No.	Height (mm)	Length (mm)	SS Thickness (mm)	Color
SBQ259-8H	8	2440	0.8 / 1.0	1S,2S,3S,4S
SBQ259-10H	10	2440	0.8 / 1.0	1B,2B,3B,4B
SBQ259-12.5H	12.5	2440	0.8 / 1.0	1F,1BA

* The color and size can be customized.
Color option refer to (Page 6).

INSTRUCTIONS:

1. Cut profile to the desired length and apply the adhesive on the support where the profile will be laid.
2. Remove carefully any remains of oil, fat and dirt from the surface where the profile will be laid.
3. Apply the adhesive to the surface of the substrate.
4. Press the profile into the adhesive, press it without hitting.
5. Apply adhesive to the back of the tile, lay the tiles on the profile and substrate aligning them.
6. Remove immediately all the remains of grout from the surface of the profile and tile.



SLE883 STAINLESS STEEL 304/316

SLE883 is a skirting profile by bending, made of stainless steel grade 304 or 316, with LED lighting system. There are shiny, brushed or BA finish surface for option. The colors of regular PVD process can be: silver, gold, champagne gold, rose gold, black, etc. We provide full set accessories for quick installation. It's widely applied to protection and transition of wall.

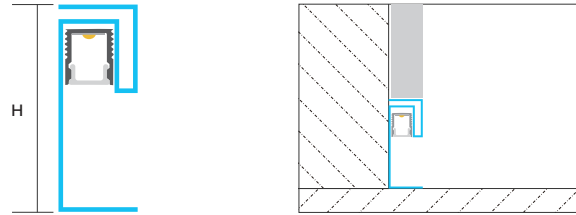

Item No.	Height (mm)	Length (mm)	SS Thickness (mm)	Voltage
SLE883	30	2440	0.8 / 1.0	12V / 24V

* The color and size can be customized.
Color option refer to (Page 6).
Lamp belts and transformers need to be purchased separately.

INSTRUCTIONS:

1. Cut profiles of suitable lengths as required.
2. Turn on the power to test whether the cable is connected and whether the LED light is normal.
3. Fix profiles to the wall by adhesive.
4. Use tile-seem filling or adhesive to fill the gap between the profile and the wall.
5. Remove immediately all the remains of grout from the surface of the profile.
6. Turn on the power.

SL133 STAINLESS STEEL 304/316



SL133 is a design of 304 stainless steel by bending into "L" shape. It is the practical profile for the balcony edge. The profiles have perforated fixed wings which can be firmly combined with the base. The bottom of the profile extends outward to guide the discharge of rain. SL133 can be used with a variety of ceramic tile and natural stone, we can not only design commonly used product dimensions, but also can make customized design for what customer needs.

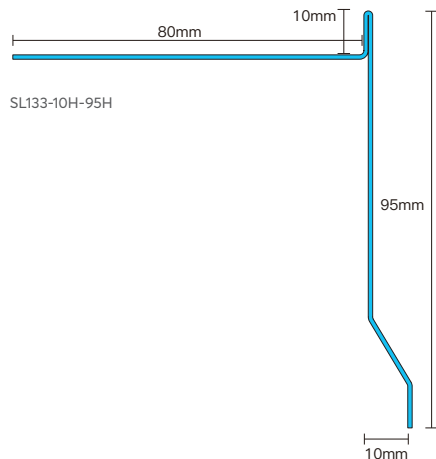
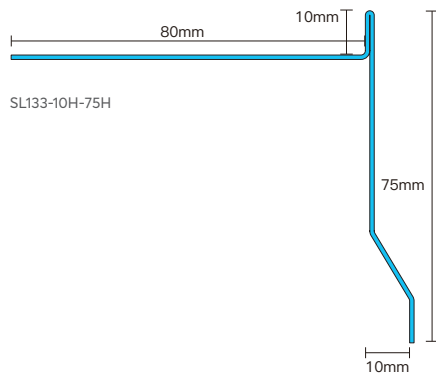
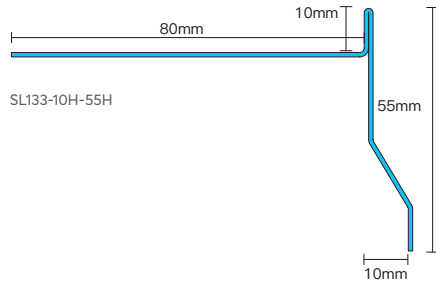
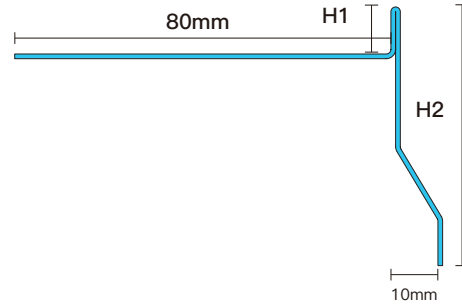

Item No.	H1 (mm)	H2 (mm)	Length (mm)	SS Thickness (mm)	Color
SL133-10H-55H	10	55	2440	0.8 / 1.0	1S,1B 1F,1BA
SL133-12.5H-55H	12.5	55	2440	0.8 / 1.0	
SL133-15H-55H	15	55	2440	0.8 / 1.0	
SL133-20H-55H	20	55	2440	0.8 / 1.0	
SL133-10H-75H	10	75	2440	0.8 / 1.0	
SL133-12.5H-75H	12.5	75	2440	0.8 / 1.0	
SL133-15H-75H	15	75	2440	0.8 / 1.0	
SL133-20H-75H	20	75	2440	0.8 / 1.0	
SL133-10H-95H	10	95	2440	0.8 / 1.0	
SL133-12.5H-95H	12.5	95	2440	0.8 / 1.0	
SL133-15H-95H	15	95	2440	0.8 / 1.0	
SL133-20H-95H	20	95	2440	0.8 / 1.0	

* The color and size can be customized. Color option refer to (Page 6).

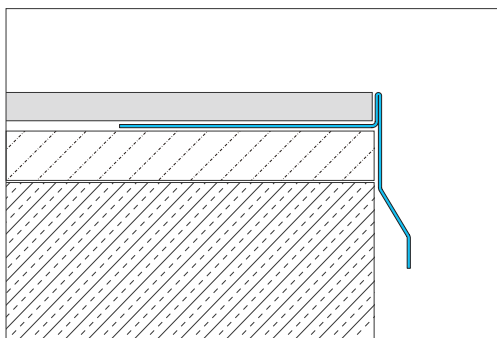

INSTRUCTIONS:

1. Cut the length of the profile as required
3. Apply tile adhesive to the balcony floor substrate and press the fixed wing into the adhesive.
4. Spread tile or natural stone on the adhesive, and clean the residual adhesive on the surface of tile and profile immediately
5. Fill in the gap between tile and profile with seam filler, then remove immediately all the remains of egrout from the surface of the profile.

TILE EDGING PROFILES

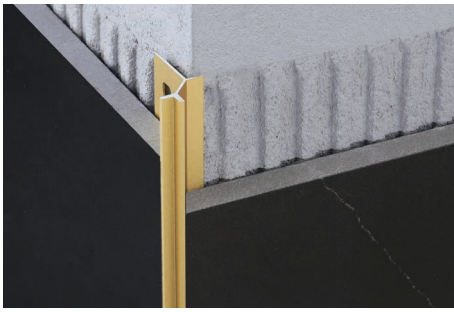

AJY7735 ALUMINUM

AJY7735 is square edging profile by moulding, made of aluminum, with either shiny, brushed or matt surface. The color with regular anodized process can be: silver, gold, champagne gold, rose gold, black, etc.

It's widely applied to corners and edging of tiles, stones, wooden laminates.

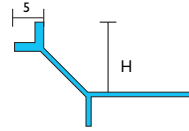

Item No.	Height (mm)	Length (mm)	Color
AJY7735-10H	10	2500	1S,2S,3S,4S, 1M,2M,3M,4M

- * The color and size can be customized.
Color option refer to (Page 5).
The product is not suitable for outdoor use

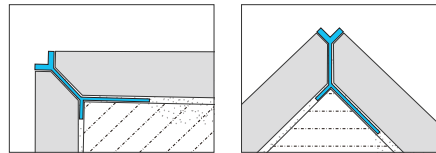

INSTRUCTIONS:

1. Cut profile to the desired length and apply the adhesive on the support where the profile will be laid.
2. Remove carefully any remains of oil, fat and dirt from the surface where the profile will be laid.
3. Apply the adhesive to the surface of the substrate.
4. Place the profile flat on the tile (wood board, floor or stone, etc.) and press the anchoring flange of profile into the adhesive, press it without hitting.
5. Apply adhesive to the back of the tile.
6. Fill the joints between the profile and the tiles with grout.
Remove immediately all the remains of grout from the surface of the profile and tile.

SKIRTING PROFILES



AF763 ALUMINUM

AF763 is a built-in skirting profile by moulding, made of Aluminum. with either shiny, brushed or matt surface. The color with regular anodized process can be: silver, gold, champagne gold, rose gold, black, etc. We provide full set accessories for quick installation. It's widely applied to protection and transition of wall.

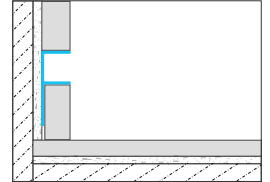
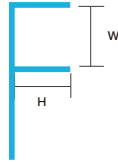

Item No.	Width (mm)	Height (mm)	Length (mm)	Color
AF763-8W	8	10/12	2500	1S,2S,3S,4S 1M,2M,3M,4M
AF763-10W	10	10/12	2500	
AF763-13W	13	10/12	2500	

* For other special materials, colors or textures, as well as other width and height customization, please contact our customer service representative.

INSTRUCTIONS:

1. Cut the profile to the desired length.
2. Apply tile adhesive to the surface of the substrate and the side of the tile, and press the fixed wing of the eprofile product into the tile adhesive.
3. Lay the tile, aligning the tile with the profile, leaving a 2mm seam.
4. Fill the joint between the profile and the tile with sealant, immediately remove all residual ceramic tile adhesive and sealant on the surface and profile.

SKIRTING PROFILES

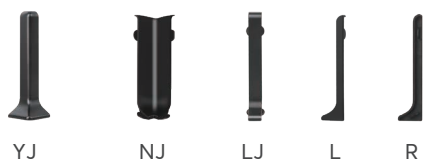

AD770 ALUMINUM

AD770 is a built-in skirting profile by moulding, made of Aluminum. with either shiny, brushed or matt surface. The color with regular anodized process can be: silver, gold, champagne gold, rose gold, black, etc. We provide full set accessories for quick installation. It's widely applied to protection and transition of wall.

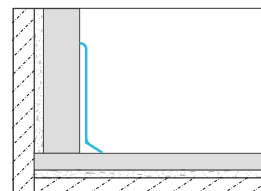

Item No.	Width (mm)	Height (mm)	Length (mm)	Color
AD770-40H	12	40	2500	12PM,1M,42M,43M,44M 45M,39PM,40PM,41PM
AD770-60H	12	60	2500	
AD770-80H	12	80	2500	

★ The color and size can be customized.

INSTRUCTIONS:

1. Cut the profile to the desired length.
2. Apply tile adhesive to the surface of the substrate and the side of the tile, and press the fixed wing of the eprofile product into the tile adhesive.
3. Lay the tile, aligning the tile with the profile, leaving a 2mm seam.
4. Fill the joint between the profile and the tile with sealant, immediately remove all residual ceramic tile adhesive and sealant on the surface and profile.

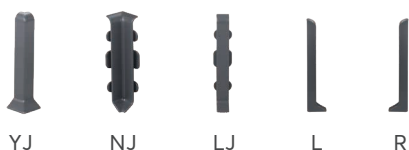

AD788 ALUMINUM

AD788 is a built-in skirting profile by moulding, made of Aluminum. with either shiny, brushed or matt surface. The color with regular anodized process can be: silver, gold, champagne gold, rose gold, black, etc. We provide full set accessories for quick installation. It's widely applied to protection and transition of wall.

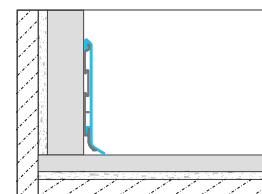

Item No.	Width (mm)	Height (mm)	Length (mm)	Color
AD788-40H	10.6	40	2500	12PM,1M,42M,43M,44M 45M,39PM,40PM,41PM
AD788-60H	10.6	60	2500	
AD788-80H	10.6	80	2500	

★ The color and size can be customized.

INSTRUCTIONS:

1. Cut the profile to the desired length.
2. Apply tile adhesive to the surface of the substrate and the side of the tile, and press the fixed wing of the profile product into the tile adhesive.
3. Lay the tile, aligning the tile with the profile, leaving a 2mm seam.
4. Fill the joint between the profile and the tile with sealant, immediately remove all residual ceramic tile adhesive and sealant on the surface and eprofile.



AD792 ALUMINUM

AD792 is a built-in skirting profile by moulding, made of Aluminum. with either shiny, brushed or matt surface. The color with regular anodized process can be: silver, gold, champagne gold, rose gold, black, etc. We provide full set accessories for quick installation. It's widely applied to protection and transition of wall.

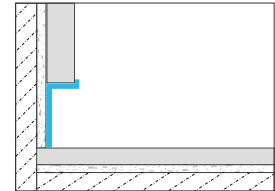
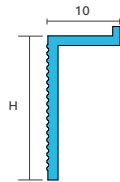

Item No.	Width (mm)	Height (mm)	Length (mm)	Color
AD792-20H	10	20	2500	12PM,1M,42M,43M 40PM,41PM

★ The color and size can be customized.

INSTRUCTIONS:

1. Cut the profile to the desired length.
2. Apply tile adhesive to the surface of the substrate and the side of the tile, and press the fixed wing of the eprofile product into the tile adhesive.
3. Lay the tile, aligning the tile with the profile, leaving a 2mm seam.
4. Fill the joint between the profile and the tile with sealant, immediately remove all residual ceramic adhesive and sealant on the surface and profile.

SKIRTING PROFILES

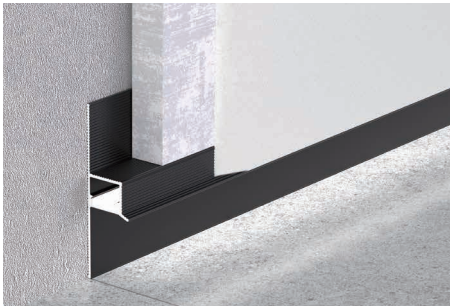

ALE8083 ALUMINUM

ALE8083 is a built-in skirting profile by moulding, made of Aluminum. with either shiny, brushed or matt surface. The color with regular anodized process can be: silver, gold, champagne gold, rose gold, black, etc. We provide full set accessories for quick installation. It's widely applied to protection and transition of wall.

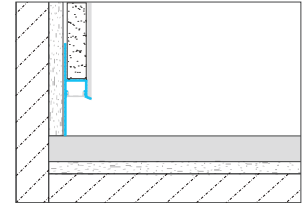
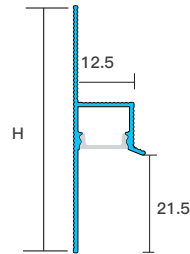

Item No.	Height (mm)	Length (mm)	Color
ALE8083-55H	55	2500/3000	1S,2S,3S,4S 1M,2M,3M,4M

- * The color and size can be customized.
Lamp belts and transformers need to be purchased separately.

INSTRUCTIONS:

1. Cut profile to the desired length and apply the adhesive on the support where the profile will be laid.
2. Remove carefully any remains of oil, fat and dirt from the surface where the profile will be laid.
3. Apply the adhesive to the surface of the substrate.
4. Place the profile flat on the tile (wood board, floor or stone, etc.) and press the anchoring flange of profile into the adhesive, press it without hitting.
5. Apply adhesive to the back of the tile.
6. Fill the joints between the profile and the tiles with grout.
Remove immediately all the remains of grout from the surface of the profile and tile.

CEILING PROFILES

Ceiling profile series is made of aluminum by moulding, built-in LED lights, with 12V/24V transformer and power supply, Ceiling profile can provide the appropriate brightness and enhance the beauty for the space. We provide a variety of sizes of the Ceiling profiles.

INSTRUCTIONS:

1. Cut the profile to the appropriate length as required.
2. Turn on the power to test whether the cable is connected and whether the LED light is normal.
3. Fix profiles to the wall, ceilings or cabinets by adhesive.
4. Remove immediately all the remains of grout from the surface of the profile.
5. Turn on the power.



ALE8084 ALUMINUM NEW

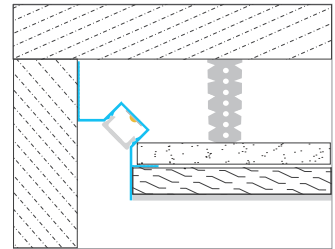
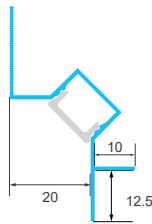

Item No.	Width (mm)	Height (mm)	Length (mm)	LED Voltage
ALE8084	20	12.5	3000	12V / 24V

Lamp belts and transformers need to be purchased separately.



ALE8084-L ALUMINUM NEW

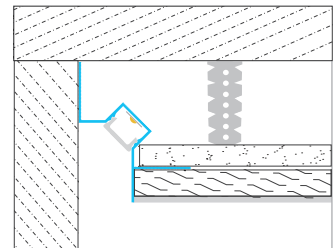
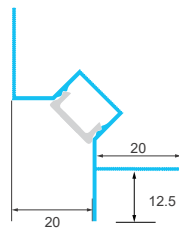

Item No.	Width (mm)	Height (mm)	Length (mm)	LED Voltage
ALE8084-L	20	12.5	3000	12V / 24V

Lamp belts and transformers need to be purchased separately.



CEILING PROFILES

Ceiling profile series is made of aluminum by moulding, built-in LED lights, with 12V/24V transformer and power supply, Ceiling profile can provide the appropriate brightness and enhance the beauty for the space. We provide a variety of sizes of the Ceiling profiles.

INSTRUCTIONS:

1. Cut the profile to the appropriate length as required.
2. Turn on the power to test whether the cable is connected and whether the LED light is normal.
3. Fix profiles to the wall, ceilings or cabinets by adhesive.
4. Remove immediately all the remains of grout from the surface of the profile.
5. Turn on the power.



ALE8073 ALUMINUM

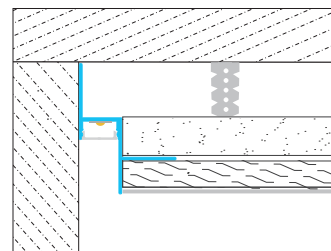
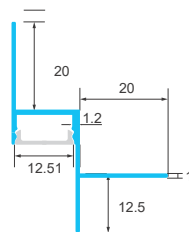

Item No.	Width (mm)	Height (mm)	Length (mm)	LED Voltage
ALE8073	12.51	12.5	3000	12V / 24V

Lamp belts and transformers need to be purchased separately.

CEILING PROFILES

Ceiling profile series is made of aluminum by moulding. It can connect the wall and ceiling, conceal unevenness at the junction of the wall and ceiling, hide pipelines, and soften the hard edges of the room through different shapes and styles, adding a sense of spatial hierarchy.

INSTRUCTIONS:

1. Cut the profile to the appropriate length as required.
2. Fix profiles to the wall, ceilings or cabinets by adhesive.
3. Remove immediately all the remains of grout from the surface of the profile.



AB7712 ALUMINUM

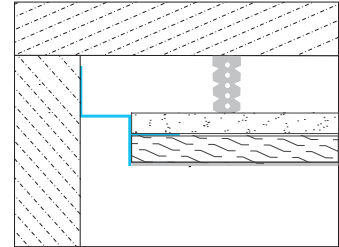
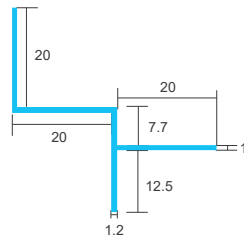

Item No.	Width (mm)	Height (mm)	Length (mm)
AB7712	20	12.5	3000

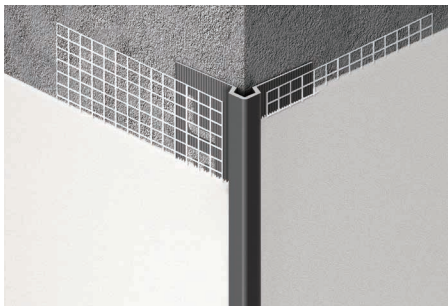

AJQ7739 ALUMINUM

It is a right-angled edge profile formed through mold processing, made of aluminum material with a smooth, frosted, or matte surface finish. Colors such as white, beige, gold, and black can be achieved through traditional anodizing or metal baking techniques. Latex paint matching the wall type and color can also be directly applied to the aluminum surface. This profile effectively prevents collisions and provides excellent protection for wall corners. Additionally, the right-angled corner features a rounded design, effectively protecting individuals from scratches.

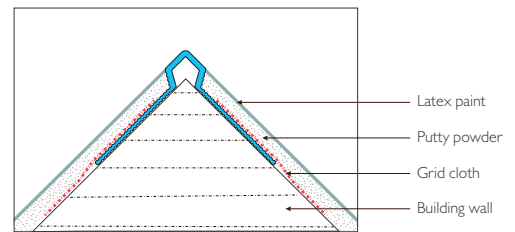
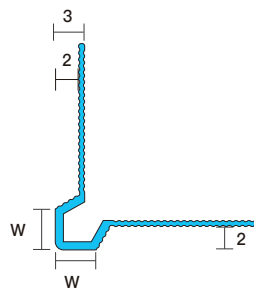

Item No.	Length (mm)	Width(mm)	Color
AJQ7739	2500/3000	5/10	1M,2M,3M,4M,6M,7M,12PS,12PM,757,758,759,760,766,767,768,769,770,4PS,4PM,771,761,763,764,765

* The color and size can be customized.
Color option refer to (Page 5).
The product is not suitable for outdoor use

INSTRUCTIONS:

- 1.Clean the substrate to ensure it is clean and free of dust and other debris.
- 2.Cut the profile into the required length. Apply a thin layer of putty powder on the substrate, and then attach the profile.
- 3.Hang and paste a mesh at the joint between the profile and the substrate. Then apply putty powder. The finished surface of the putty powder should be flush with the profile.
4. Remove the protective layer after construction is completed.

OBLIQUITY PROFILES AND GLASS PROFILES

SF217 STAINLESS STEEL 304/316

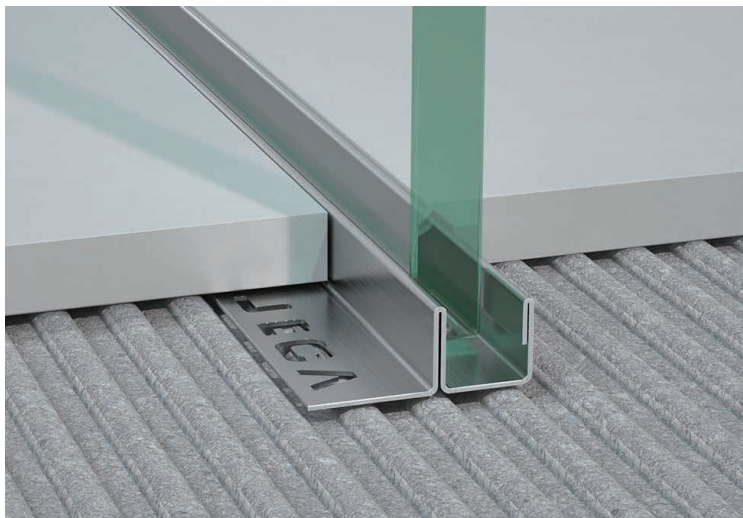

SF217 glass carrier profile is bending by 304/316 stainless steel materials, suitable for different thickness and height of ceramic tiles and glass. Secure fixing of the glass partition in the floor and wall.

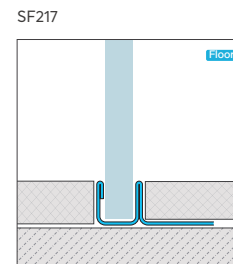
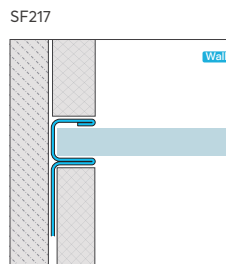

Item No.	Width (mm)	Height (mm)	Length (mm)	SS Thickness (mm)	Color
SF217-11W-10H	11	10	2440	0.8 / 1.0	1S,1B
SF217-11W-12.5H	11	12.5	2440	0.8 / 1.0	
SF217-13W-10H	13	10	2440	0.8 / 1.0	
SF217-13W-12.5H	13	12.5	2440	0.8 / 1.0	

* For other special materials, colors or textures, as well as other width and height customization, please contact our customer service representative.

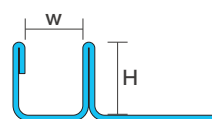

OBLIQUITY PROFILES AND GLASS PROFILES

STL252L/STL253R STAINLESS STEEL 304/316

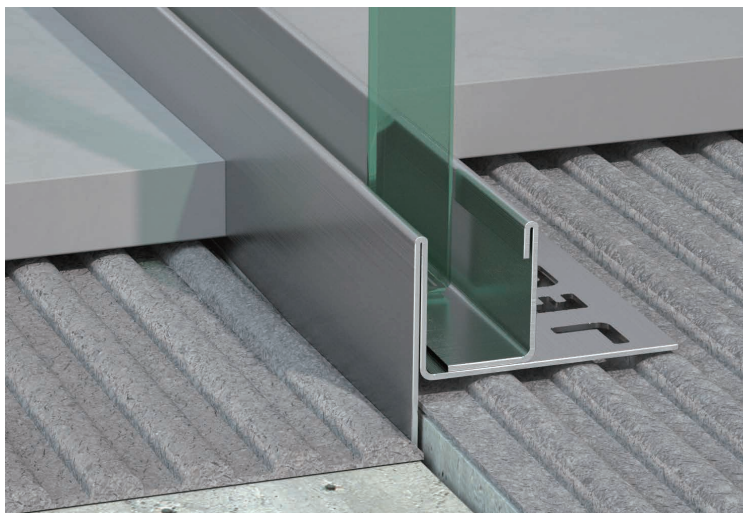

STL252L /STL253R obliquity profiles and glass profiles bending by 304 stainless steel materials, suitable for different thickness and height of ceramic tiles and glass.

- * Easy installation with a combined inclined wedge
- * Secure fixing of the glass partition in the floor and wall
- * Elegant compensation of the slope
- * 2% slope

STL252L

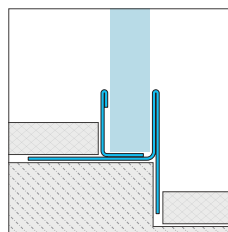

STL253R

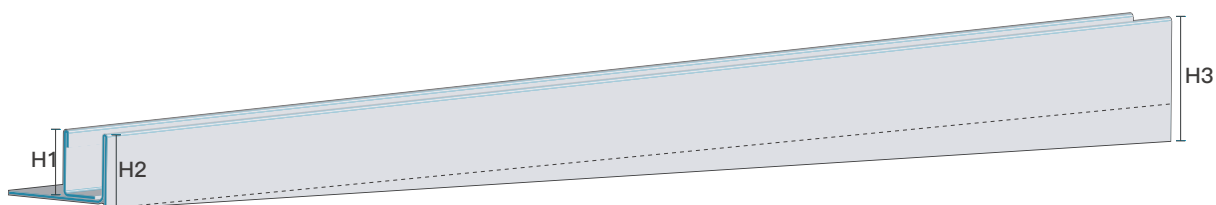
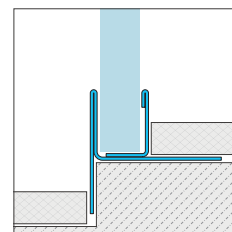

Item No.	Width (mm)	H1 (mm)	H2 (mm)	H3 (mm)	Length (mm)	SS Thickness (mm)	Color	*
STL252L-13W-19H-980L	13	19	20	37	980	0.8 / 1.0	1S,2S 3S,4S 1B,2B 3B,4B	Inclined wedge Left
STL252L-13W-19H-1200L	13	19	20	41	1200			
STL252L-13W-19H-1480L	13	19	20	47	1480			
STL252L-13W-19H-2000L	13	19	20	57	2000			
Item No.	Width (mm)	H1 (mm)	H2 (mm)	H3 (mm)	Length (mm)	SS Thickness (mm)	Color	*
STL253R-13W-19H-980L	13	19	20	37	980	0.8 / 1.0	1S,2S 3S,4S 1B,2B 3B,4B	Inclined wedge Right
STL253R-13W-19H-1200L	13	19	20	41	1200			
STL253R-13W-19H-1480L	13	19	20	47	1480			
STL253R-13W-19H-2000L	13	19	20	57	2000			

* For other special materials, colors or textures, as well as other width and height customization, please contact our customer service representative.

OBLIQUITY PROFILES AND GLASS PROFILES

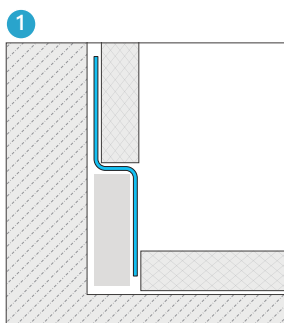
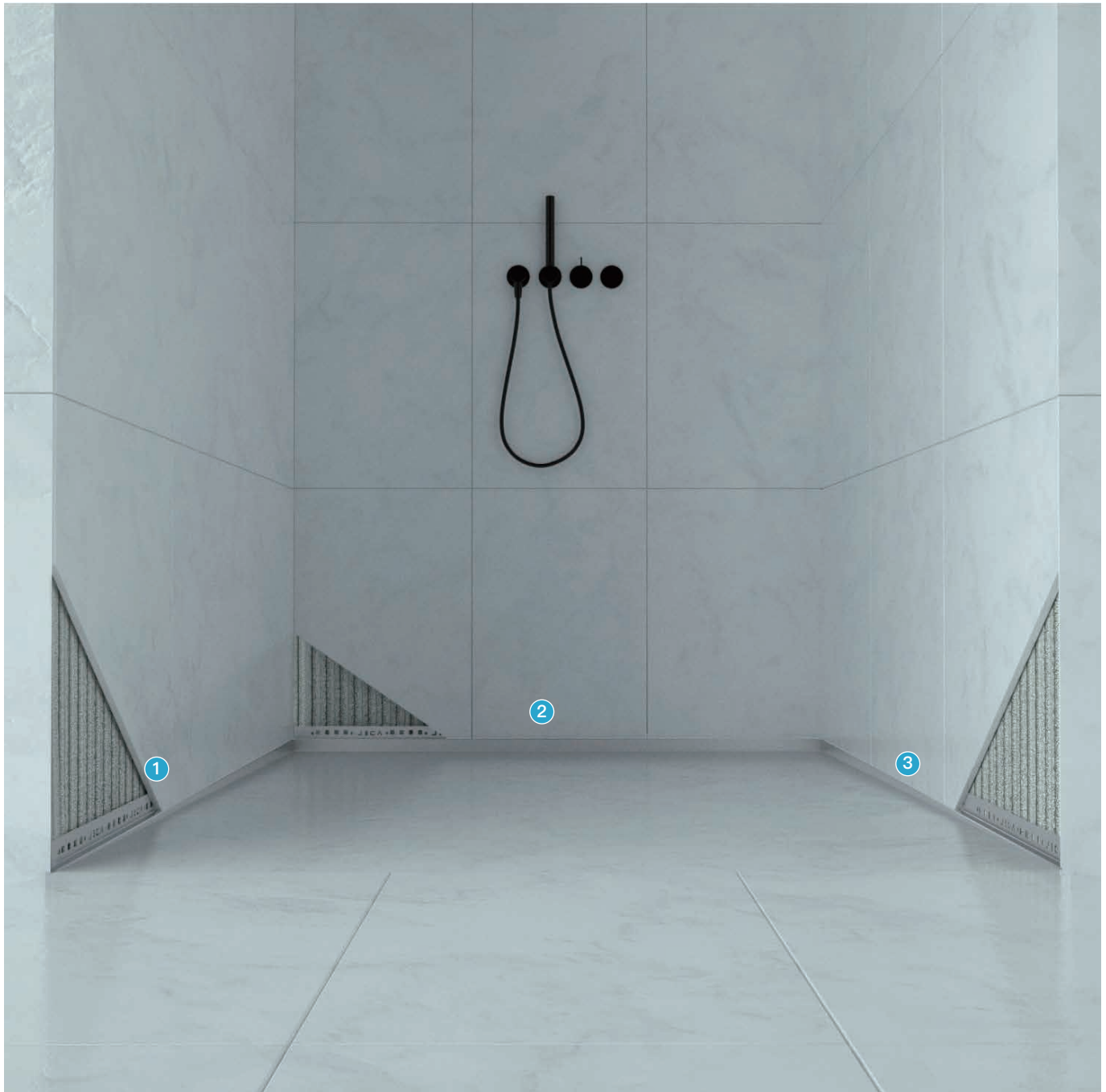

SBZ255L
* Inclined wedge-Left

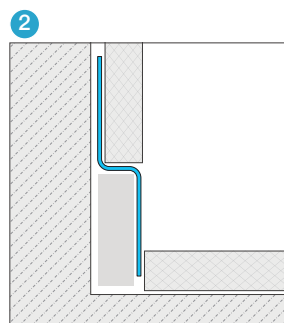

SBZ254
* Paralleled edge

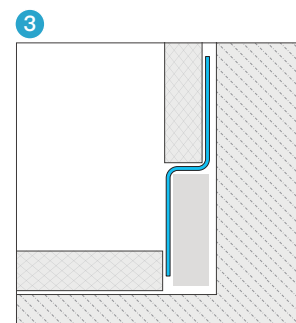

SBZ256R
* Inclined wedge-Right

OBLIQUITY PROFILES AND GLASS PROFILES

SBZ255L/SBZ256R STAINLESS STEEL 304/316



SBZ255L/SBZ256R obliquity profiles bending by 304 stainless steel materials, suitable for different thickness and height of ceramic tiles .

- * Easy installation with a inclined wedge
- * Secure fixing of the transition between wall and floor.
- * Elegant compensation of the slope
- * 2% slope

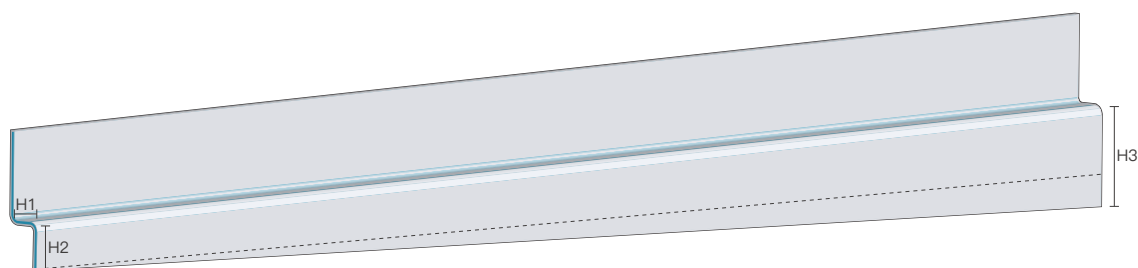
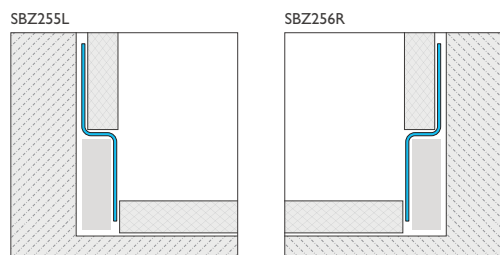

Item No.	H1 (mm)	H2 (mm)	H3 (mm)	Length (mm)	SS Thickness (mm)	Color	*
SBZ255L-8H-980L	8	8	28	980	0.8 / 1.0	1S,2S 3S,4S 1B,2B 3B,4B	Inclined wedge Left
SBZ255L-10H-980L	10	10	28	980			
SBZ255L-12.5H-980L	12.5	12.5	28	980			
SBZ255L-8H-1200L	8	8	32	1200			
SBZ255L-10H-1200L	10	10	32	1200			
SBZ255L-12.5H-1200L	12.5	12.5	32	1200			
SBZ255L-8H-1480L	8	8	38	1480			
SBZ255L-10H-1480L	10	10	38	1480			
SBZ255L-12.5H-1480L	12.5	12.5	38	1480			
SBZ255L-8H-2000L	8	8	48	2000			
SBZ255L-10H-2000L	10	10	48	2000			
SBZ255L-12.5H-2000L	12.5	12.5	48	2000			

Item No.	H1 (mm)	H2 (mm)	H3 (mm)	Length (mm)	SS Thickness (mm)	Color	*
SBZ256R-8H-980L	8	8	28	980	0.8 / 1.0	1S,2S 3S,4S 1B,2B 3B,4B	Inclined wedge Right
SBZ256R-10H-980L	10	10	28	980			
SBZ256R-12.5H-980L	12.5	12.5	28	980			
SBZ256R-8H-1200L	8	8	32	1200			
SBZ256R-10H-1200L	10	10	32	1200			
SBZ256R-12.5H-1200L	12.5	12.5	32	1200			
SBZ256R-8H-1480L	8	8	38	1480			
SBZ256R-10H-1480L	10	10	38	1480			
SBZ256R-12.5H-1480L	12.5	12.5	38	1480			
SBZ256R-8H-2000L	8	8	48	2000			
SBZ256R-10H-2000L	10	10	48	2000			
SBZ256R-12.5H-2000L	12.5	12.5	48	2000			

* For other special materials, colors or textures, as well as other width and height customization, please contact our customer service representative.

OBLIQUITY PROFILES AND GLASS PROFILES

SBZ254 STAINLESS STEEL 304/316



SBZ254 Tile profiles bending by 304 steel materials, suitable for different thickness and height of ceramic tiles .

* Easy installation together with Inclined wedge and glass carrier profiles .

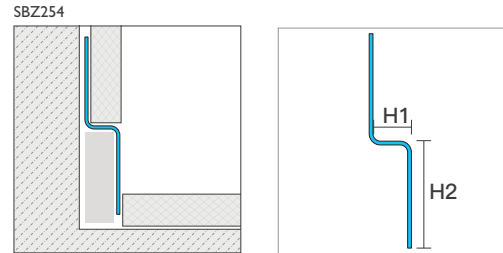

Item No.	H1 (mm)	H2 (mm)	Length (mm)	SS Thickness (mm)	Color	*
SBZ254-8/28H-1000L	8	28	1000	0.8 / 1.0	1S,2S 3S,4S 1B,2B 3B,4B	Paralleled egde
SBZ254-8/32H-1000L	8	32	1000			
SBZ254-8/38H-1000L	8	38	1000			
SBZ254-8/48H-1000L	8	48	1000			
SBZ254-8/28H-1500L	8	28	1500			
SBZ254-8/32H-1500L	8	32	1500			
SBZ254-8/38H-1500L	8	38	1500			
SBZ254-8/48H-1000L	8	48	1500			

Item No.	H1 (mm)	H2 (mm)	Length (mm)	SS Thickness (mm)	Color	*
SBZ254-10/28H-1000L	10	28	1000	0.8 / 1.0	1S,2S 3S,4S 1B,2B 3B,4B	Paralleled egde
SBZ254-10/32H-1000L	10	32	1000			
SBZ254-10/38H-1000L	10	38	1000			
SBZ254-10/48H-1000L	10	48	1000			
SBZ254-10/28H-1500L	10	28	1500			
SBZ254-10/32H-1500L	10	32	1500			
SBZ254-10/38H-1500L	10	38	1500			
SBZ254-10/48H-1000L	10	48	1500			

Item No.	H1 (mm)	H2 (mm)	Length (mm)	SS Thickness (mm)	Color	*
SBZ254-12.5/28H-1000L	12.5	28	1000	0.8 / 1.0	1S,2S 3S,4S 1B,2B 3B,4B	Paralleled egde
SBZ254-12.5/32H-1000L	12.5	32	1000			
SBZ254-12.5/38H-1000L	12.5	38	1000			
SBZ254-12.5/48H-1000L	12.5	48	1000			
SBZ254-12.5/28H-1500L	12.5	28	1500			
SBZ254-12.5/32H-1500L	12.5	32	1500			
SBZ254-12.5/38H-1500L	12.5	38	1500			
SBZ254-12.5/48H-1000L	12.5	48	1500			

* For other special materials, colors or textures, as well as other width and height customization, please contact our customer service representative.

OBLIQUITY PROFILES AND GLASS PROFILES

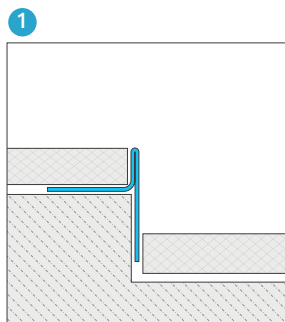
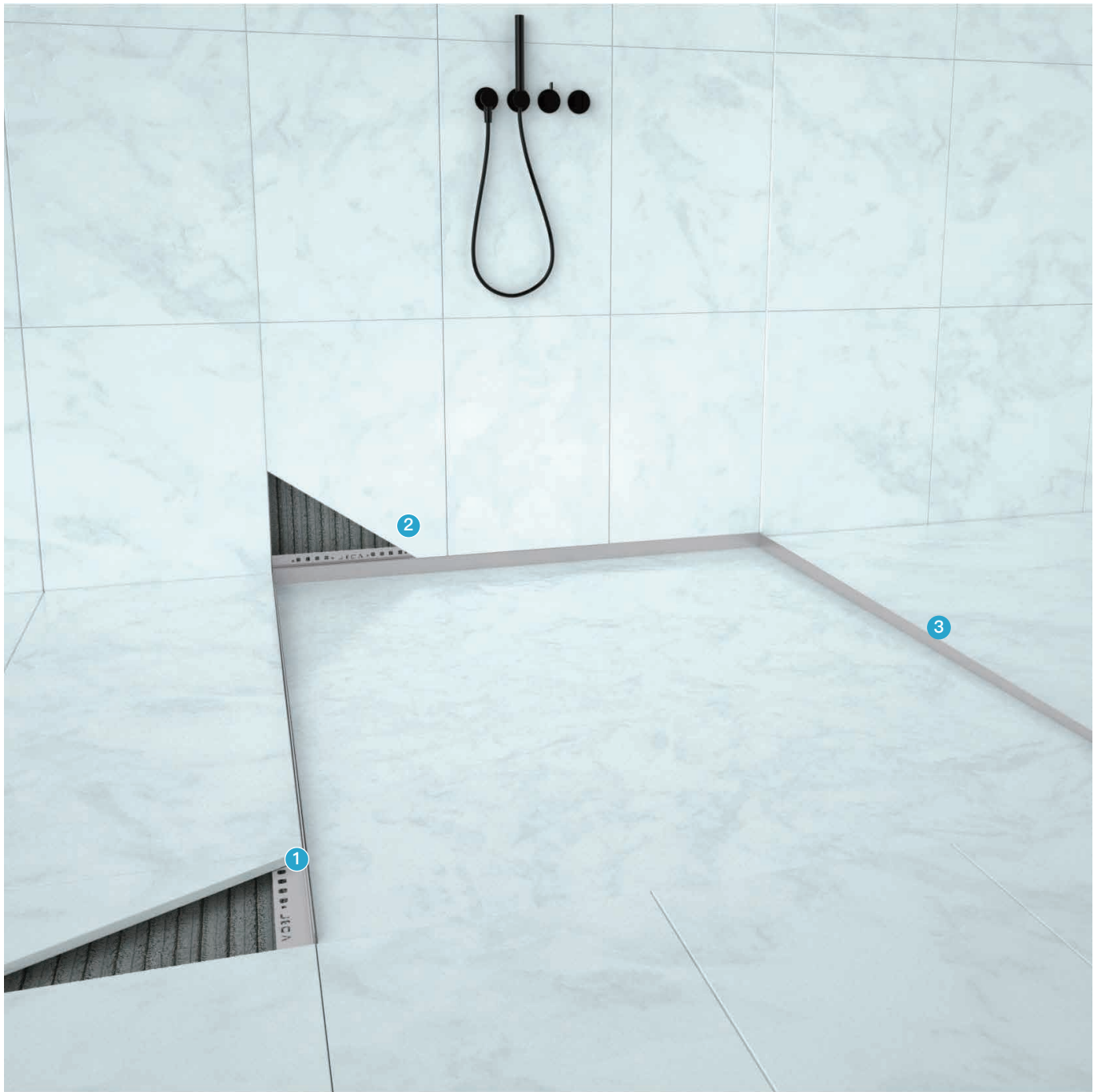

SL194L

* Inclined wedge-Left

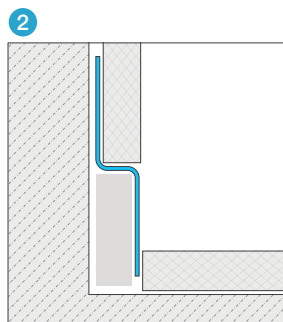

SBZ254

* Paralleled edge

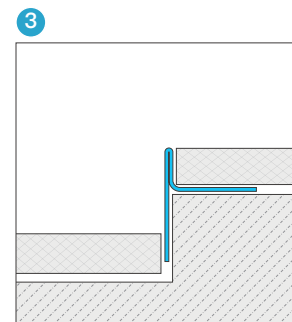

SL195R

* Inclined wedge-Right

OBLIQUITY PROFILES AND GLASS PROFILES

SLI 94L/SLI 95R STAINLESS STEEL 304/316



SLI 94L/SLI 95R obliquity profiles bending by 304 stainless steel materials, suitable for different thickness and height of ceramic tiles and glass.

- * Easy installation with a inclined wedge
- * Elegant compensation of the slope
- * 2% slope

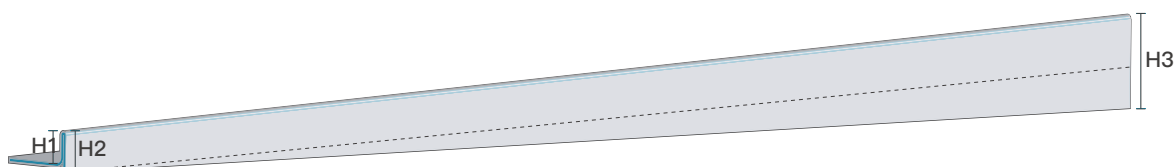
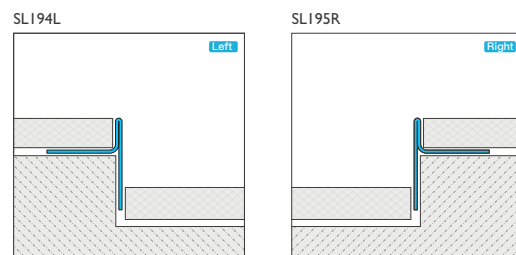

Item No.	H1 (mm)	H2 (mm)	H3 (mm)	Length (mm)	SS Thickness (mm)	Color	*
SL194L-8H-980L	8	8+T	28	980	0.8 / 1.0	1S,2S 3S,4S 1B,2B 3B,4B	Inclined wedge Left
SL194L-10H-980L	10	10+T	28	980			
SL194L-12.5H-980L	12.5	12.5+T	28	980			
SL194L-8H-1200L	8	8+T	32	1200			
SL194L-10H-1200L	10	10+T	32	1200			
SL194L-12.5H-1200L	12.5	12.5+T	32	1200			
SL194L-8H-1480L	8	8+T	38	1480			
SL194L-10H-1480L	10	10+T	38	1480			
SL194L-12.5H-1480L	12.5	12.5+T	38	1480			
SL194L-8H-2000L	8	8+T	48	2000			
SL194L-10H-2000L	10	10+T	48	2000			
SL194L-12.5H-2000L	12.5	12.5+T	48	2000			

Item No.	H1 (mm)	H2 (mm)	H3 (mm)	Length (mm)	SS Thickness (mm)	Color	*
SL195R-8H-980L	8	8+T	28	980	0.8 / 1.0	1S,2S 3S,4S 1B,2B 3B,4B	Inclined wedge Right
SL195R-10H-980L	10	10+T	28	980			
SL195R-12.5H-980L	12.5	12.5+T	28	980			
SL195R-8H-1200L	8	8+T	32	1200			
SL195R-10H-1200L	10	10+T	32	1200			
SL195R-12.5H-1200L	12.5	12.5+T	32	1200			
SL195R-8H-1480L	8	8+T	38	1480			
SL195R-10H-1480L	10	10+T	38	1480			
SL195R-12.5H-1480L	12.5	12.5+T	38	1480			
SL195R-8H-2000L	8	8+T	48	2000			
SL195R-10H-2000L	10	10+T	48	2000			
SL195R-12.5H-2000L	12.5	12.5+T	48	2000			

* For other special materials, colors or textures, as well as other width and height customization, please contact our customer service representative.

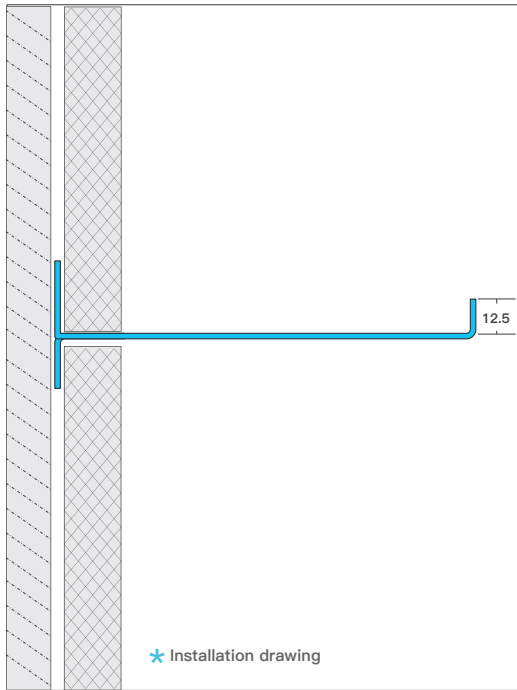

* Installation drawing

S-SHELF I292

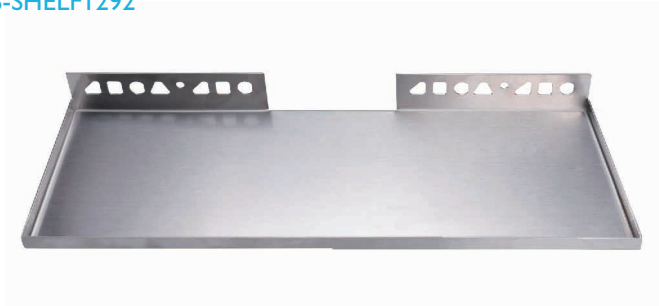

Item No.	SS Thickness (mm)	Color	Height (mm)
S-SHELF 1292	1.2	Silver Brushed	12.5

NICHE WITHOUT PARTITION



SBK298 STAINLESS STEEL 304/316

SBK298 is made of 304 or 316 stainless steel with brushed and matt. the regular colors with PVD process can be: silver brushed;gold brushed;rose gold brushed;grey brushed;black brushed ;matt black with luxury painting.The size can be customized.Widely used in bathroom decoration and TV background etc.

Item No.	Width(mm)	Height (mm)	Depth(mm)	SS Thickness(mm)
SBK298-300	300	300	120	1.0
SBK298-600	600	300	120	1.0
SBK298-900	900	300	120	1.0
SBK298-1200	1200	300	120	1.0

Remarks:The Color and size can be customized

INSTRUCTIONS:

According to the size of the drawing, open the wall hole or build the wall hole. Smooth the bottom of the wall hole to ensure that the niche is closely fitted to the wall and installed smoothly. Fill the joint between the niche and the wall with sealant, and immediately remove the residual sealant on the surface and niche.

COLOR OPTIONS:

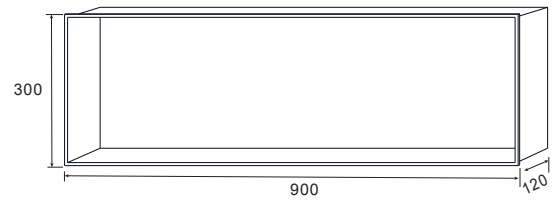
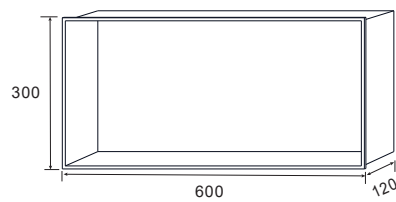
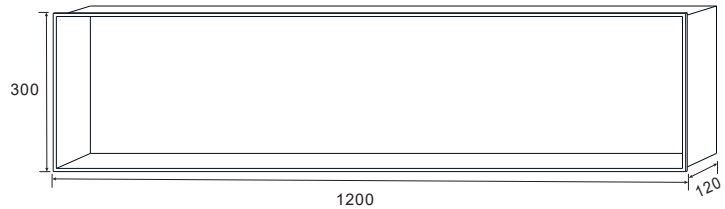
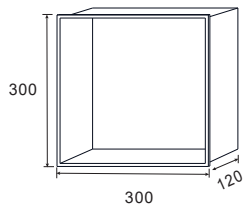
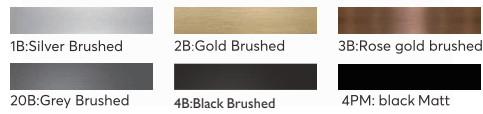

NICHE WITH LED LIGHTS



SBK298-LED STAINLESS STEEL 304/316

SBK298-LED is made of 304 or 316 stainless steel with brushed and matt. the regular colors with PVD process can be: silver brushed;gold brushed;rose gold brushed;grey brushed;black brushed;matt black with luxury painting.The size can be customized.Widely used in bathroom decoration and TV background etc.

Item No.	Width(mm)	Height (mm)	Depth(mm)	SS Thickness(mm)
SBK298-LED-300	300	300	120	1.0
SBK298-LED-600	600	300	120	1.0
SBK298-LED-900	900	300	120	1.0
SBK298-LED-1200	1200	300	120	1.0

Remarks:The Color and size can be customized
Lamp belts and transformers need to be purchased separately.

INSTRUCTIONS:

According to the size of the drawing, open the wall hole or build the wall hole.
Smooth the bottom of the wall hole to ensure that the niche is closely fitted to the wall and installed smoothly.
Fill the joint between the niche and the wall with sealant, and immediately remove the residual sealant on the surface and niche.

COLOR OPTIONS:

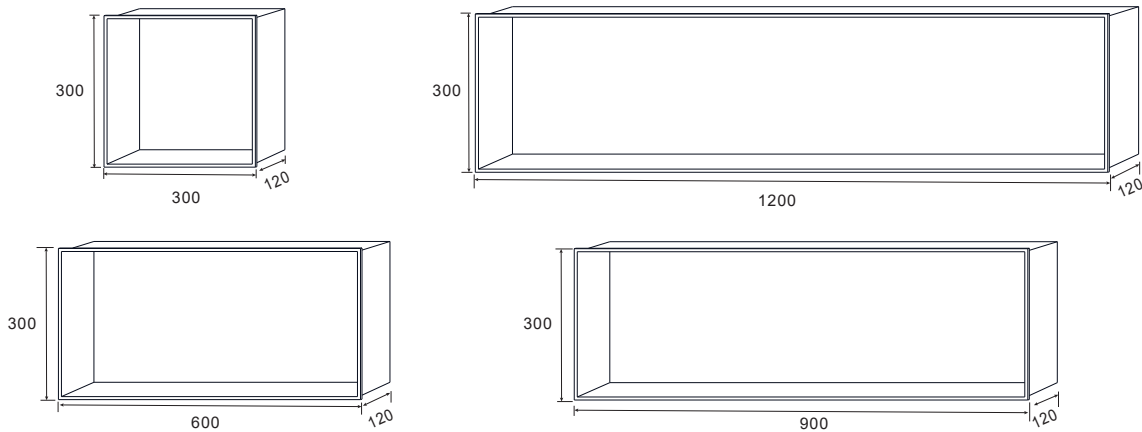
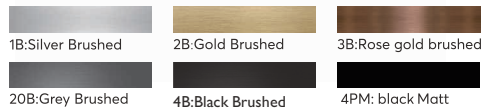

NICHE WITH PARTITION



SBK298 STAINLESS STEEL 304/316

SBK298 is made of 304 or 316 stainless steel with brushed and matt. the regular colors with PVD process can be: silver brushed;gold brushed;rose gold brushed;grey brushed;black brushed ;matt black with luxury painting.The size can be customized.Widely used in bathroom decoration and TV background etc.

Item No.	Width(mm)	Height (mm)	Depth(mm)	SS Thickness(mm)
SBK298-300	300	300	120	1.0
SBK298-600	300	600	120	1.0
SBK298-900	300	900	120	1.0
SBK298-1200	300	1200	120	1.0

Remarks:The Color and size can be customized

COLOR OPTIONS:

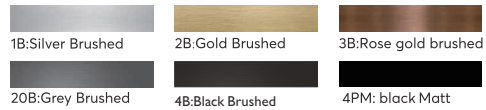

INSTRUCTIONS:

According to the size of the drawing, open the wall hole or build the wall hole. Smooth the bottom of the wall hole to ensure that the niche is closely fitted to the wall and installed smoothly. Fill the joint between the niche and the wall with sealant, and immediately remove the residual sealant on the surface and niche.

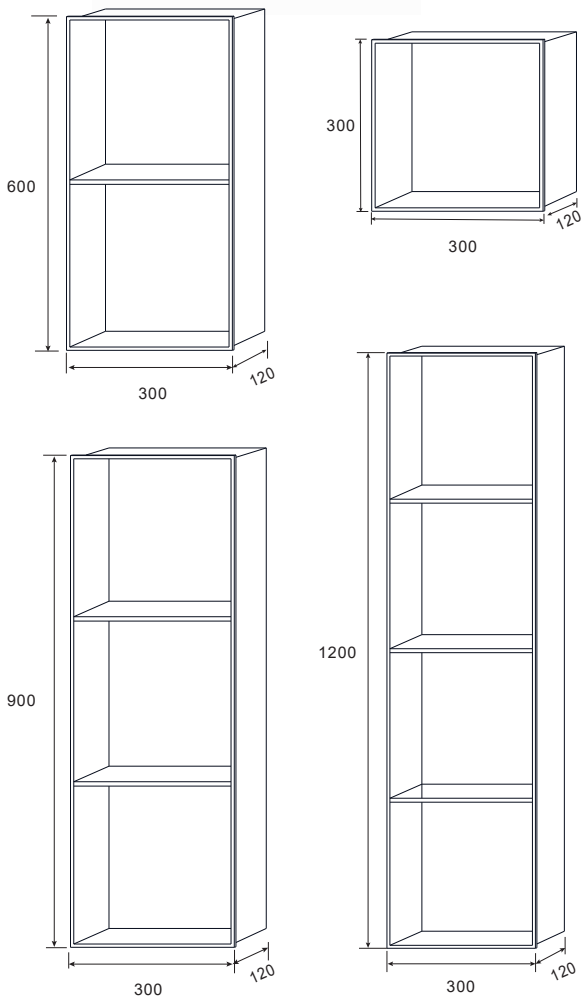

NICHE WITH PARTITION & LED LIGHTS



SBK298-LED STAINLESS STEEL 304/316

SBK298-LED is made of 304 or 316 stainless steel with brushed and matt. the regular colors with PVD process can be: silver brushed;gold brushed;rose gold brushed;grey brushed;black brushed ;matt black with luxury painting.The size can be customized.Widely used in bathroom decoration and TV background etc.

Item No.	Width(mm)	Height (mm)	Depth(mm)	SS Thickness(mm)
SBK298-LED-300	300	300	120	1.0
SBK298-LED-600	300	600	120	1.0
SBK298-LED-900	300	900	120	1.0
SBK298-LED-1200	300	1200	120	1.0

Remarks:The Color and size can be customized
Lamp belts and transformers need to be purchased separately.

COLOR OPTIONS:

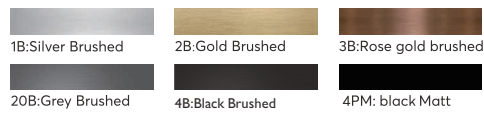

INSTRUCTIONS:

According to the size of the drawing, open the wall hole or build the wall hole.
Smooth the bottom of the wall hole to ensure that the niche is closely fitted to the wall and installed smoothly.
Fill the joint between the niche and the wall with sealant, and immediately remove the residual sealant on the surface and niche.

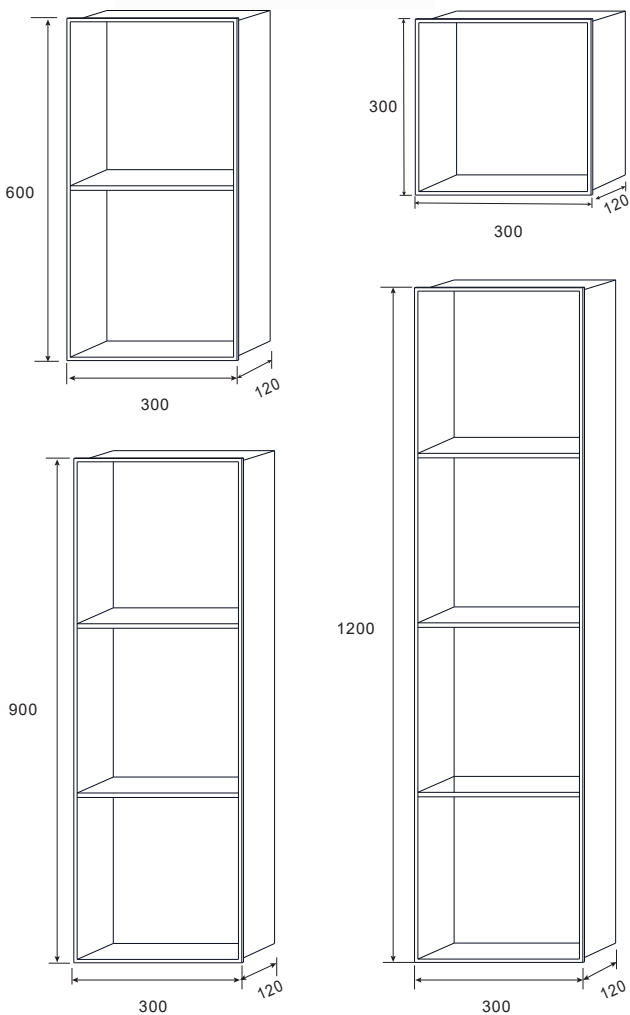

NICHE WITHOUT PARTITION



COLOR OPTIONS:

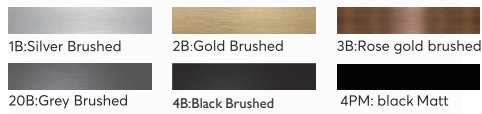

SBK304 WITH PUNCHING HOLES

SBK304 is made of 304 or 316 stainless steel with brushed and matt. the regular colors with PVD process can be: silver brushed;gold brushed;rose gold brushed;grey brushed;black brushed ;matt black with luxury painting.The size can be customized.Widely used in bathroom decoration and TV background etc.

Item No.	Width(mm)	Height (mm)	Depth(mm)	SS Thickness(mm)
SBK304-300	300	300	120	1.0
SBK304-600	600	300	120	1.0
SBK304-900	900	300	120	1.0
SBK304-1200	1200	300	120	1.0

Remarks:The Color and size can be customized

INSTRUCTIONS:

According to the size of the drawing, open the wall hole or build the wall hole. Smooth the bottom of the wall hole to ensure that the niche is closely fitted to the wall and installed smoothly. Fill the joint between the niche and the wall with sealant, and immediately remove the residual sealant on the surface and niche.

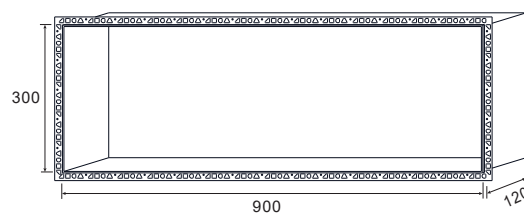
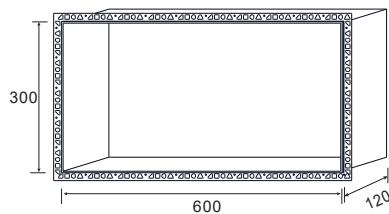
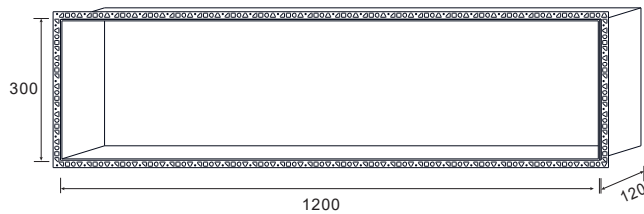
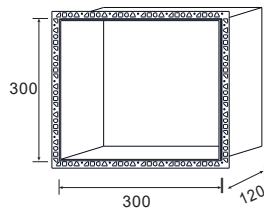

TILEABLE NICHE FRAME

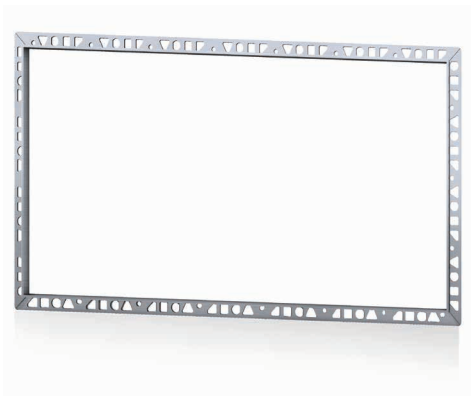

SBKK323-3 STAINLESS STEEL 304/316

SBKK323-3 is made of 304 or 316 stainless steel with brushed and matt. the regular colors with PVD process can be: silver brushed;gold brushed;rose gold brushed;grey brushed;black brushed ;matt black with luxury painting.The size can be customized.Widely used in bathroom decoration and TV background etc.

Item No.	Length(mm)	Width(mm)	Height(mm)	SS Thickness(mm)
SBKK323-300	300	300	10/12	0.8/1.0
SBKK323-600	600	300		
SBKK323-900	900	300	10/12	

Remarks:The Color and size can be customized

COLOR OPTIONS:

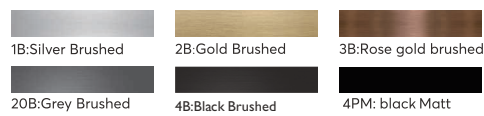

INSTRUCTIONS:

According to the size of the drawing, open the wall hole or build the wall hole. Smooth the bottom of the wall hole to ensure that the niche is closely fitted to the wall and installed smoothly. Fill the joint between the niche and the wall with sealant, and immediately remove the residual sealant on the surface and niche.

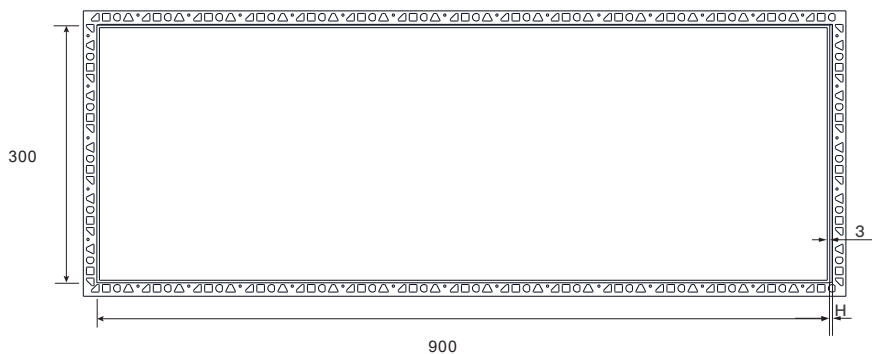
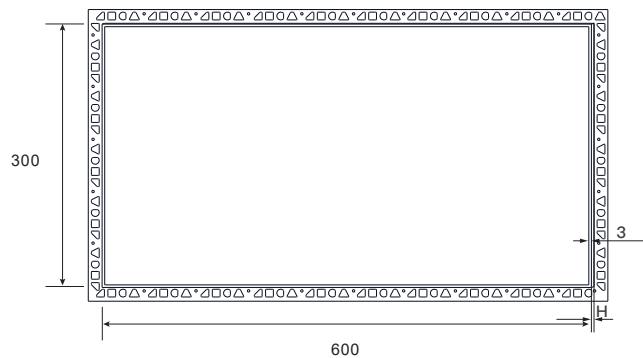
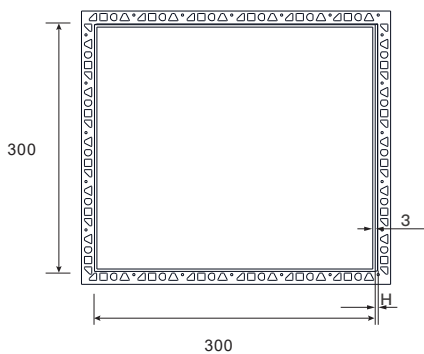

MOVEMENT JOINT PROFILES

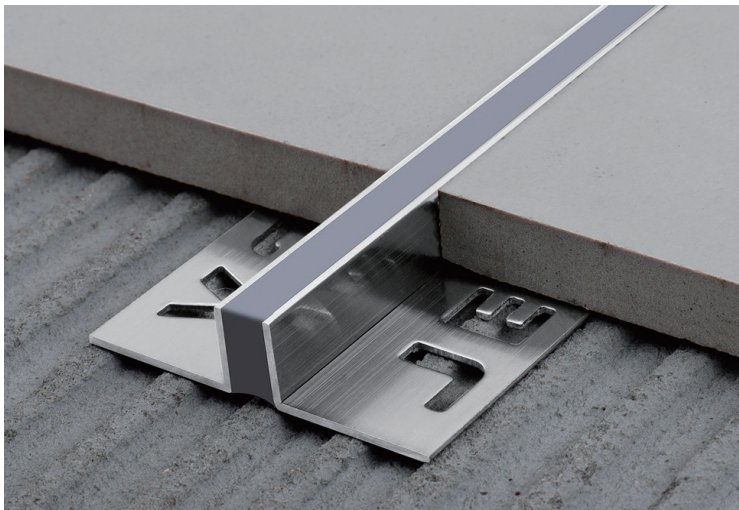

SMLP246 STAINLESS STEEL 304/316

SMLP246 Movement joint profiles is constructed with stainless steel (304) edges and is filled with a colored silicone. This siliconed movement zone is available in multiple colors to coordinate with tiles color and helps to absorb movement caused by shrinkage, structure settling, substrate expansion and contraction, and vibration. The top of profile is polished, so the flatness is perfect.

Material: Stainless steel(304)
Infill: High quality silicone

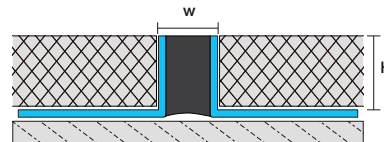

Item No.	Width (mm)	Height (mm)	Length (mm)	SS Thickness (mm)
SMLP246-8W-8H	8	8	2440	0.8 / 1.0
SMLP246-8W-10H	8	10	2440	0.8 / 1.0
SMLP246-8W-12.5H	8	12.5	2440	0.8 / 1.0
SMLP246-8W-15H	8	15	2440	0.8 / 1.0
SMLP246-10W-8H	10	8	2440	0.8 / 1.0
SMLP246-10W-10H	10	10	2440	0.8 / 1.0
SMLP246-10W-12.5H	10	12.5	2440	0.8 / 1.0
SMLP246-10W-15H	10	15	2440	0.8 / 1.0

* For other special materials, colors or textures, as well as other width and height customization, please contact our customer service representative.

SILICONE COLOR

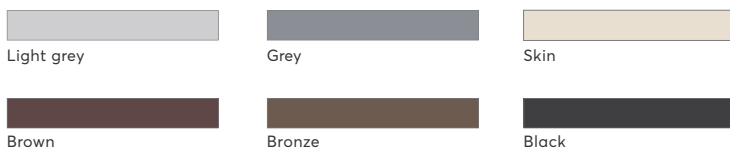

TILE EDGING PROFILES



BJL605 H53-58# EXTRUDED BRASS

BJL605 is a L shape edging profile by moulding, made of H53-H58 brass, with either polished, brushed or natural surface.

Perfect edge protection covers in heights from 10-15mm.

It's widely applied to corners and edging of tiles, stones, wooden laminates, floorboards.

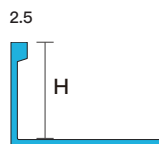

Item No.	Height (mm)	Length (mm)	Color
BJL605-10H	10	2500	17PL(NATURAL BRASS), 17SS(POLISHED BRASS)
BJL605-12.5H	12.5	2500	17BS(BRUSHED BRASS)

* The size can be customized.

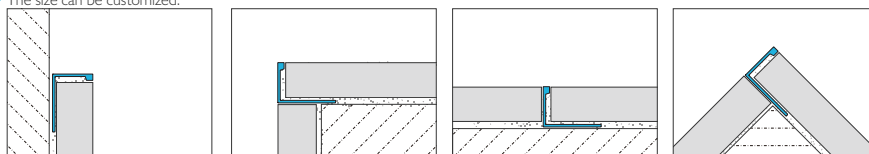

INSTRUCTIONS:

1. Cut profile to the desired length and apply the adhesive on the support where the profile will be laid.
 2. Clean the residue or grease on the substrate, tile or stone.
 3. Apply the adhesive to the surface of the substrate.
 4. Press the anchoring flange of profile into the adhesive.
 5. Apply adhesive to the back of the tile, lay the tiles on floor and wall aligning them with the profile leaving a 2mm joint.
 6. Fill the joints between the profile and the tiles with grout, in order to avoid water stagnation.
- Remove immediately all the remains of grout from the surface of the profile and tile.

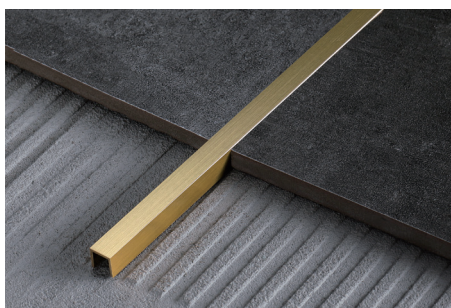

BJU10 H53-58# EXTRUDED BRASS

BJU10 is a U shape decorative profile by moulding, made of H53-H58 brass, with either polished, brushed or natural surface,

Profile covers in width from 10-15mm.

It's widely applied to flooring transition, wall decorative strips of tiles, stones, wooden laminates, floorboards.

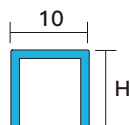

Item No.	Height (mm)	Length (mm)	Color
BJU10	10	2500	17PL(NATURAL BRASS), 17SS(POLISHED BRASS) 17BS(BRUSHED BRASS)

* The size can be customized.

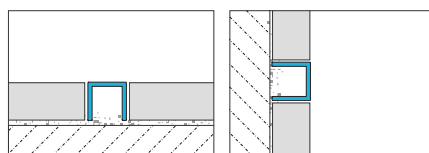

INSTRUCTIONS:

1. Cut profile to the desired length and apply the adhesive on the support where the profile will be laid.
2. Remove carefully any remains of oil, fat and dirt from the surface where the profile will be laid.
3. Apply the adhesive to the surface of the substrate.
4. Place the profile flat on the tile (wood board, floor or stone, etc.) and press the anchoring flange of profile into the adhesive, press it without hitting.
5. Apply adhesive to the back of the tile, lay the tiles on floor and wall aligning them with the profile leaving a 2mm joint.
6. Fill the joints between the profile and the tiles with grout. Remove immediately all the remains of grout from the surface of the profile and tile.

TILE PROFILES FOR TRANSITIONS



BJL605 H53-58# EXTRUDED BRASS

BJL605 is a L shape transition profile, made of H53-H58 brass, with either polished, brushed or natural surface.

Profile covers in heights from 10-15mm.

It's widely applied to transition of tile, stone, wooden laminates, floorboards and wall decorative strips.

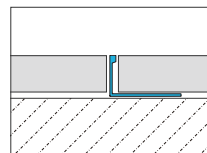
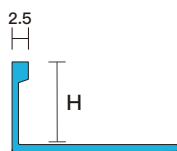

Item No.	Height (mm)	Length (mm)	Color
BJL605-10H	10	2500	17PL(NATURAL BRASS) , 17SS(POLISHED BRASS)
BJL605-12.5H	12.5	2500	17BS(BRUSHED BRASS)

* The size can be customized.

INSTRUCTIONS:

1. Cut profile to the desired length and apply the adhesive on the support where the profile will be laid.
2. Clean the residue or grease on the substrate, tile or stone.
3. Apply the adhesive to the surface of the substrate.
4. Press the anchoring flange of profile into the adhesive.
5. Apply adhesive to the back of the tile, lay the tiles on floor and wall aligning them with the profile leaving a 2mm joint.
6. Fill the joints between the profile and the tiles with grout, in order to avoid water stagnation.
Remove immediately all the remains of grout from the surface of the profile and tile.



BJL607 H53-58# EXTRUDED BRASS

BJL607 is a L shape transition profile by moulding, made of H53-H58 brass, with either polished, brushed or natural surface.

Profile covers in heights from 8-15mm.

It's widely applied for transition of tile, stone, wooden laminates, floorboards and wall decorative strips.

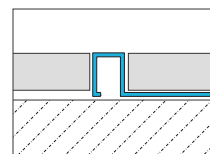
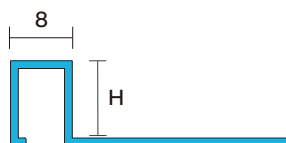

Item No.	Height (mm)	Length (mm)	Color
BJL607-8H	8	2500	17PL(NATURAL BRASS) , 17SS(POLISHED BRASS)
BJL607-10H	10	2500	17BS(BRUSHED BRASS)
BJL607-12.5H	12.5	2500	17BS(BRUSHED BRASS)

* The size can be customized.

INSTRUCTIONS:

1. Cut profile to the desired length and apply the adhesive on the support where the profile will be laid.
2. Clean the residue or grease on the substrate, tile or stone.
3. Apply the adhesive to the surface of the substrate.
4. Press the anchoring flange of profile into the adhesive.
5. Apply adhesive to the back of the tile, lay the tiles on floor and wall aligning them with the profile leaving a 2mm joint.
6. Fill the joints between the profile and the tiles with grout, in order to avoid water stagnation.
Remove immediately all the remains of grout from the surface of the profile and tile.

TILE PROFILES FOR TRANSITIONS

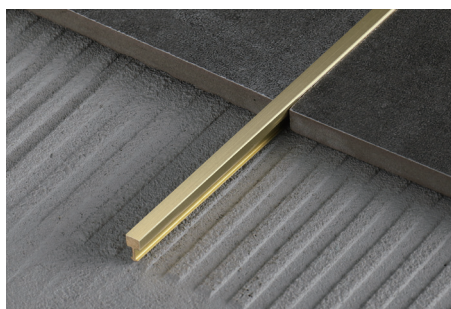

BJT5 H53-58# EXTRUDED BRASS

BJT5 is a T shape transition profile by moulding, made of H53-H58 brass, with either polished, It's widely applied to transition of tile, stone, wooden laminates, floorboards.

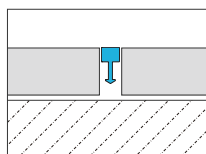
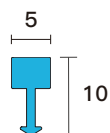

Item No.	Height (mm)	Length (mm)	Color
BJT5	10	2500	17PL(NATURAL BRASS) , 17SS(POLISHED BRASS) 17BS(BRUSHED BRASS)

★ The size can be customized.

INSTRUCTIONS:

1. Cut profile to the desired length and apply the adhesive on the support where the profile will be laid.
2. Remove carefully any remains of oil, fat and dirt from the surface where the profile will be laid.
3. Apply the adhesive to the surface of the substrate.
4. Insert the profile into the gap between the tile (wood board, floor or stone, etc.).
5. Remove immediately all the remains of grout from the surface of the profile and tile (wood board, floor or stone, etc.).



BJT5B-25H H53-58# EXTRUDED BRASS

BJT5B-25H is a T shape transition profile by moulding, made of H53-H58 brass, with either polished.

It's widely applied to transition of tile, stone, wooden laminates, floorboards.

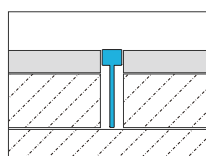
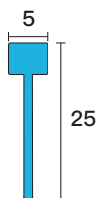

Item No.	Height (mm)	Length (mm)	Color
BJT5B-25H	25	2500	17PL(NATURAL BRASS) , 17SS(POLISHED BRASS) 17BS(BRUSHED BRASS)

★ The size can be customized.

INSTRUCTIONS:

1. Cut profile to the desired length and apply the adhesive on the support where the profile will be laid.
2. Remove carefully any remains of oil, fat and dirt from the surface where the profile will be laid.
3. Apply the adhesive to the surface of the substrate.
4. Insert the profile into the gap between the tile (wood board, floor or stone, etc.).
5. Remove immediately all the remains of grout from the surface of the profile and tile (wood board, floor or stone, etc.).

